

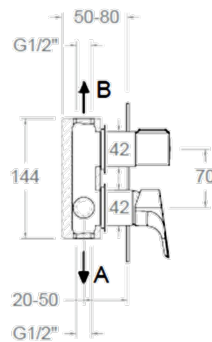

## SPECIFICATION SHEET

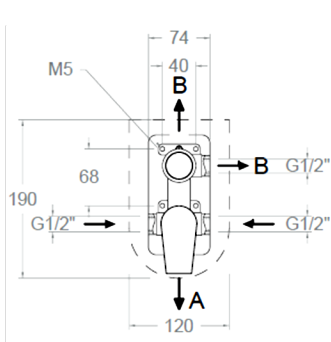

XX1503	1 bar	3 bar	5 bar
A l/min	13	22	28
B l/min	13	21	26
B l/min	13	21	26
KIT DE AMPLIACIÓN - EXTENSION SET: KA2V			



### Technical Characteristics :

- ◆ Ceramic cartridge Ø42 mm.
- ◆ Cartridge: 35100 (6689-2) + 4003.
- ◆ Thermostatic cartridge with hot block system to protect against scalding and thermostat system to lock the temperature at 38 °.
- ◆ Delivery at 3 bar 22 l / min.
- ◆ Noise level at 3 bar: <20 dB.
- ◆ Chrome plated brass: 15 micron nickel, 0.3 micron chrome.
- ◆ Resistant to static pressure ≤ 10 bar and water hammer 25 bar.
- ◆ Recommended hot water temperature 55 ° C. Maximum use temperature 65 ° C. Maximum 1 h at 90 ° C.
- ◆ Use a pressure between 1-5 bar. 3 bars recommended.
- ◆ 5 years warranty for faucets and 2 years for accessories
- ◆ Patented water management system.

### MANUFACTURER

RAMON SOLER - SPAIN

### MODEL

URBAN CHIC

### DESCRIPTION

SINGLE LEVER 3 WAY BUILT-IN SHOWER MIXER WITH METALIC PLATE WITHOUT SHOWER KIT

### FINISH

CHROME

### CODE

211503S